



# **ONE-FAMILY AND TWO-FAMILY KITS**

Download from  
[www.urmetdomus.com](http://www.urmetdomus.com)  
Technical manuals area



## SECTION 5 CONTENTS

### DOOR PHONE AND VIDEO DOOR PHONE SYSTEM - PRODUCT TECHNICAL MANUAL

**urmet**  
DOMUS

Diagrams Section Pag.

#### ONE-FAMILY AND TWO-FAMILY KITS

##### 'AUDIO TWO' DOOR PHONE KIT WITH SMYLE PANEL

DEVICES .....	5	3
ACCESSORIES .....	5	3
SPARE PARTS .....	5	3
TECHNICAL FEAUTURES .....	5	3
PANEL INSTALLATION .....	5	3
APARTMENT STATION INSTALLATION .....	5	5
Adjusting the call volume .....	5	5
TRANSFORMER INSTALLATION .....	5	5
WIRING DIAGRAMS .....	5	6

##### 2-WIRE ONE FAMILY VIDEO KIT

DEVICES .....	5	7
ACCESSORIES .....	5	7
SPARE PARTS .....	5	7
TECHNICAL FEAUTURES .....	5	7
WIRE CROSS-SECTION AREA .....	5	7
PANEL .....	5	8
Installation .....	5	8
VIDEO DOOR PHONE .....	5	10
Installation .....	5	10
POWER SUPPLY .....	5	10
BASIC KIT CONNECTION .....	SV102-3216	5 10

SUPPLEMENTARY RINGER Ref. 9854/41 CONNECTION IN PARALLEL TO 1 VIDEO DOOR PHONE CALL CALL REPEATER RELAY CONNECTION FOR CONTROLLING A SUPPLEMENTARY RINGER CONNECTION OF A SECONDARY ELECTRICAL LOCK .....	SV102-3217B	5 12
---	-------------	------

ONE DOOR PHONE Ref. 1133 CONNECTION IN PARALLEL TO THE VIDEO DOOR PHONE ONE ATLANTICO VIDEO DOOR PHONE CONNECTION IN PARALLEL TO THE VIDEO DOOR PHONE .....	SV102-3218	5 13
--	------------	------

##### ONE AND TWO-FAMILY VIDEO KIT Mod. 956 WITH ARTICO VIDEO DOOR PHONE

EQUIPMENT .....	5	14
ACCESSORIES .....	5	14
SPARE PARTS .....	5	14
TECHNICAL FEATURES .....	5	14
WIRE SECTIONS .....	5	14
CAMERA UNIT .....	5	15
Installation .....	5	15
VIDEO DOOR PHONE .....	5	17
Installation .....	5	17
POWER SUPPLY .....	5	17

ONE FAMILY KIT CONNECTION Ref. 956/31 .....	SV102-2082C	5 18
---	-------------	------

TWO-FAMILY KIT CONNECTION Ref. 956/32 .....	SV102-2081B	5 19
---	-------------	------

CONNECTION OF 2 ARTICO VIDEO DOOR PHONES IN PARALLEL .....	SV102-2135C	5 20
--	-------------	------

CONNECTION OF 2 VIDEO DOOR PHONES TO 2 VIDEO DOOR UNITS. INDIVIDUAL CALLS FROM VIDEO DOOR UNIT .....	SV102-3225	5 21
---	------------	------

CONNECTION OF 1 DOOR PHONE IN PARALLEL TO 1 VIDEO DOOR PHONE SIMULTANEOUS OPENING OF 2 LOCKS .....	SV102-2136E	5 22
---	-------------	------

CONNECTION OF SUPPLEMENTARY RING Ref. 9854/41 IN PARALLEL TO VIDEO DOOR PHONE CALL CONNECTION TO CALL REPEATER RELAY FOR CONTROLLING A SUPPLEMENTARY RINGER .....	SV102-2137D	5 23
--	-------------	------

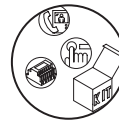

## 'AUDIO TWO' DOOR PHONE KIT WITH SMYLE PANEL

The "audio two" door phone kit is used to make one-family door phone systems with electrical door lock release using only two wires to connect the door phone to the door unit.

The following Audio Two door phone kits are available:

- With plastic panel **Ref. 1129/10**
- With zama vandal-proof panel **Ref. 1129/21**

**NOTE:** the panels with plastic casing are provided with 35 x 56mm name tags; those with zama casing are provided with 15 x 56mm name tags.

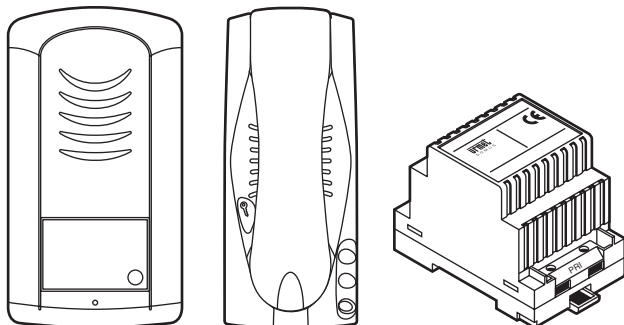

A conversation can be established by picking up the door phone handset after receiving a call from the door unit.

In addition to an auxiliary button for supplementary services (e.g. switching on staircase lights, operating electrical door locks, etc.), the door phone is equipped with a control for adjusting call volume. Maximum, minimum or mute volume can be selected. A red tab will appear on the right-hand side of the door phone to indicate that the call tone has been muted.

An additional ringer (Ref. 9854/41) can be connected to the door phone. The additional ringer output level is fixed and does not depend on the door phone ringing level setting.

The volumes can be adjusted during installation by means of the loudspeaking unit controls.

The name tag on the speaker is back-lit with 2 LEDs.

The electric lock can be operated at the end of the conversation by pressing the button on the door phone.

A mechanically released electric lock must be used (single pulse opening).

The maximum distance between the transformer and the door unit must be less than 110m.

## DEVICES

The base kit has the following devices:

- Atlantico door phone with door opening button and 1 supplementary button.
- Smyle Door speaker unit with one call button.
- Power transformer 230/12Vac.

## ACCESSORIES

The following accessories may be purchased separately:

- Additional ringer **Ref. 9854/41**
- Additional door phone buttons **Ref. 1133/55**
- Tabletop installation support **Ref. 1133/50**
- Supplementary door phone (6 wires) **Ref. 1129/51**

## SPARE PARTS

The following spare parts are provided for repairs:

- Atlantico Door phone **Ref. 1129/110**
- Door unit **Ref. 1129/112**
- Transformer 230/12Vac **Ref. 9000/230**

## TECHNICAL FEATURES

Power supply:	230Vac $\pm$ 10% 50-60Hz
Transformer output:	12Vac (nominal)
Transformer power:	18VA max.
Protection Electronic:	electronic fuse PTC (*)
Electrical lock:	12Vac
Power unit-door unit distance:	Max. 110m
Wire cross-section area:	
distance = 60m	0,5mm <sup>2</sup>
distance = 90m	0,75mm <sup>2</sup>
distance = 110m	1mm <sup>2</sup>

(\*) Disconnect the main power for at least 60" to reset the power unit if the PTC trips due to overload or short-circuit.

## PANEL INSTALLATION

- Remove the name tag light circuit.

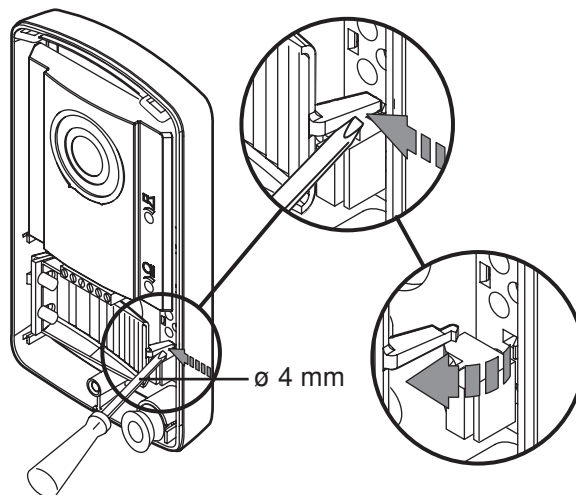

- Extract the door unit from the base.

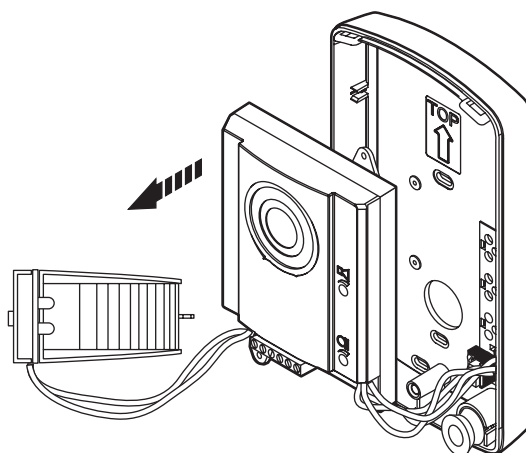



# 'AUDIO TWO' DOOR PHONE KIT WITH SMYLE PANEL

## PANEL INSTALLATION

**urmet**  
DOMUS

- Fasten the base onto a flat wall at the height shown in the figure using the bolts provided.

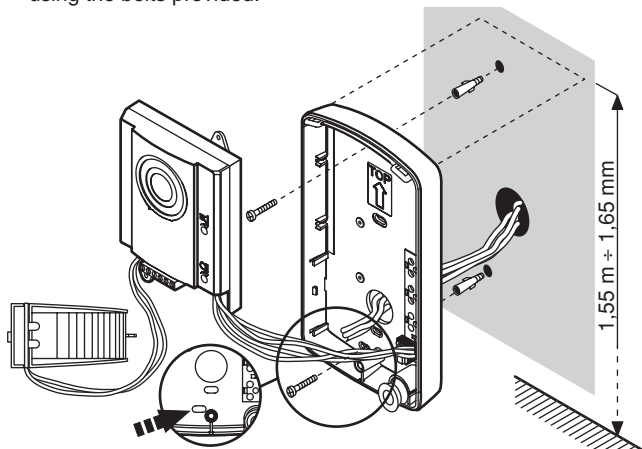

**NOTE:** the panels with plastic casing may also be fixed in a flush-mounting box Mod. 503 as shown below.

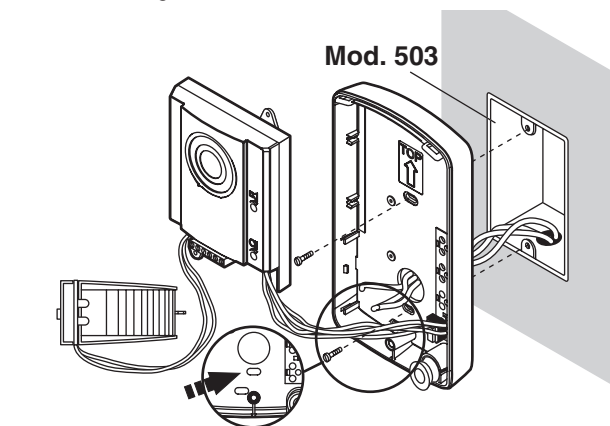

- Insert the door unit into the compartment in the based and connect the wires (it is advisable to have approximately 40-45mm of wire protruding from the wall).

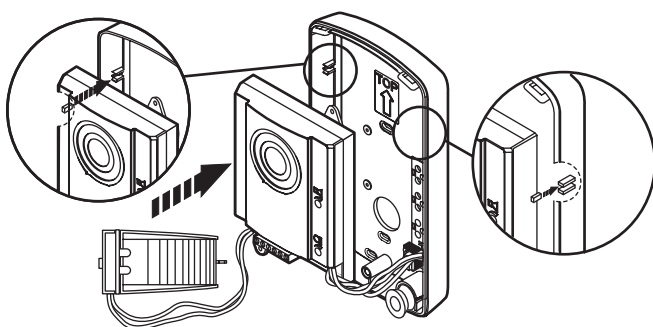

- Fasten the name tag light circuit making the wires pass underneath the support.

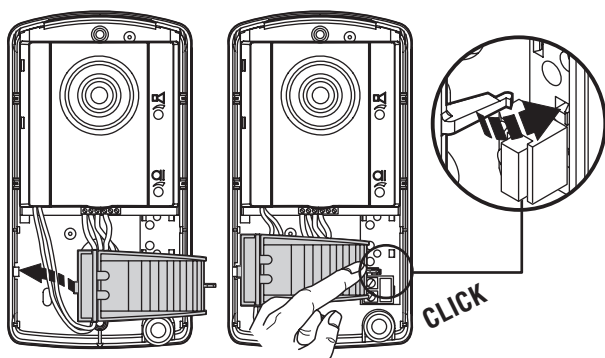

- Adjust volume. Volume is calibrated to optimal values during production. Change the settings when needed only.

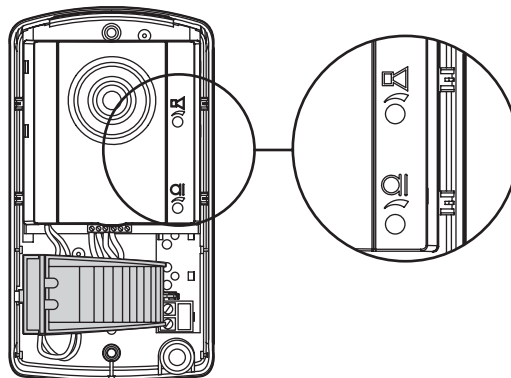

- Write the name on the name tag and insert in the housing.

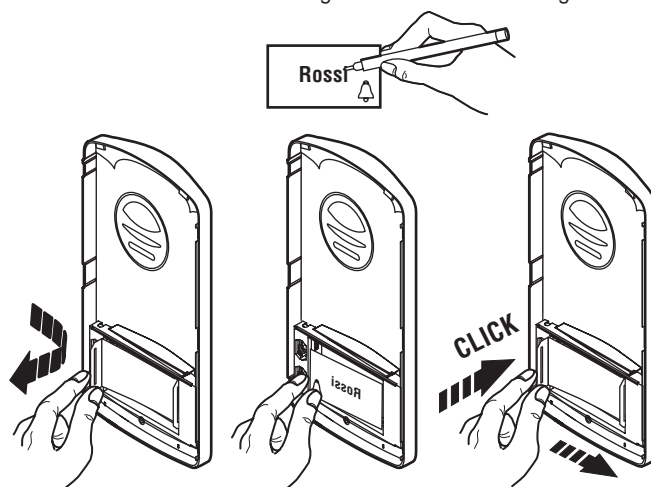

- Insert the front part of the panel on the base and fasten it with the socket head screw using the wrench (2mm) provided.

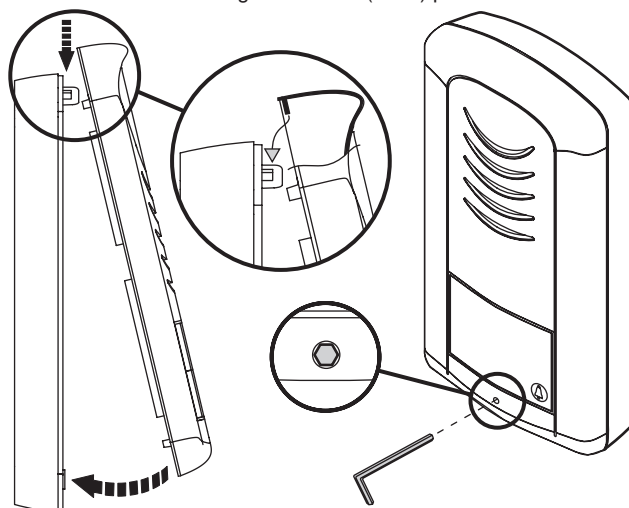



## APARTMENT STATION INSTALLATION

To remove the door phone top, lever with the tip of a screwdriver in the area shown and remove it by turning it on the upper tabs.

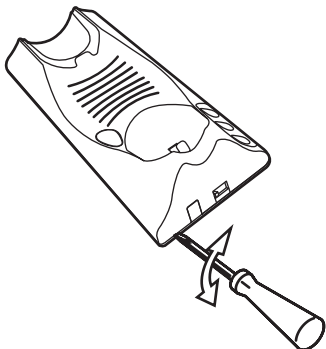

Use the holes on the base to fasten the door phone to the wall. Use the bolts provided with each device.

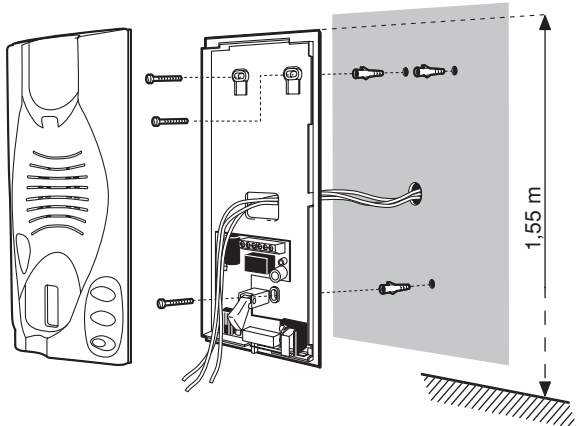

**NOTE:** fasten the door phone to the call with the bolts provided for flush-mounting in Mod.503 boxes.

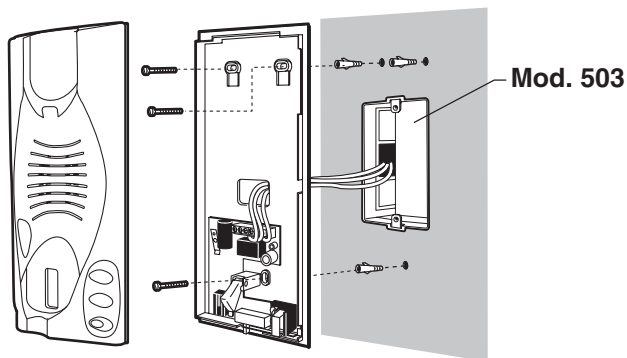

Refit the door phone top after installation.

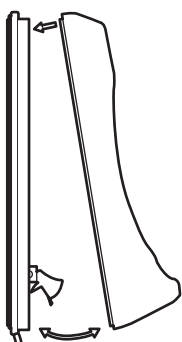

The handset connector telephone plug into the door phone base.

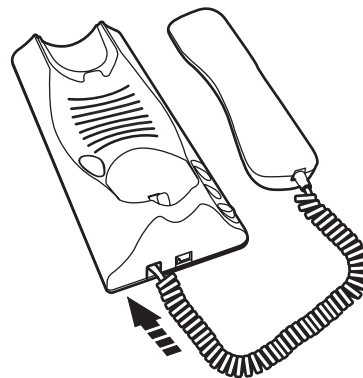

## ADJUSTING THE CALL VOLUME

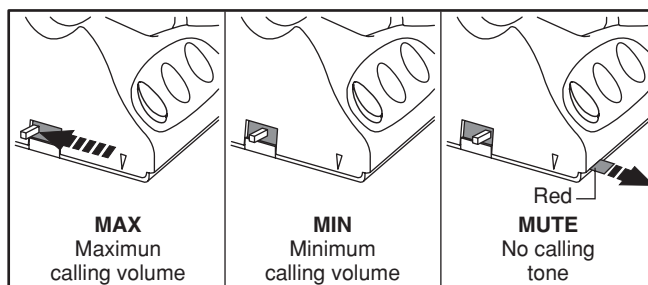

## TRANSFORMER INSTALLATION

Before connecting the transformer to the mains, disconnect the mains switch.

Fit the protective cover on the network terminals after connecting the system.

Disconnect the mains power supply for 60" to reset the transformer if the PTC thermal switch trips due to overload or short-circuit.

Use lever "A" to remove the transformer fitted on a DIN rail.

### Fitting to DIN rail

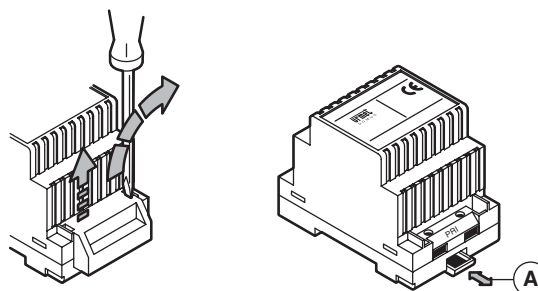

### Wall fitting

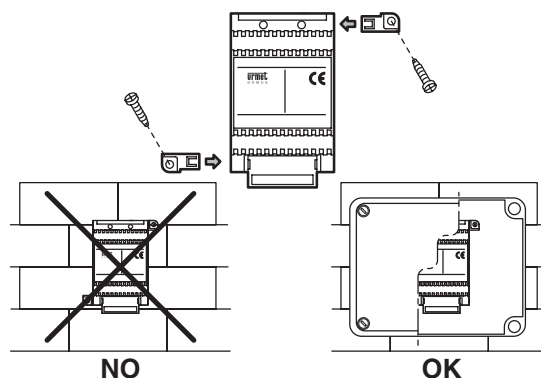



# ‘AUDIO TWO’ DOOR PHONE KIT WITH SMYLE PANEL

## WIRING DIAGRAMS

**urmet**  
DOMUS

## WIRING DIAGRAMS

**NOTE:** a total of up to 5 devices (1 main door phone and 4 door phones Ref.1129/51, or 2 door phones Ref.1129/51 with 2 supplementary ringers Ref. 9854/41) may be installed.

The supplementary ringers Ref.9854/41 must be connected to terminals S+, S-. The ringers connected to terminals S+ and S- of the main door phone are connected to the main door phone calling volume trimmer while the ringers connected to the supplementary door phones Ref. 1129/51 will always ring at the maximum possible volume.

### CONNECTION OF ONE FAMILY 2-WIRE AUDIO KIT WITH AN ADDITIONAL RINGER

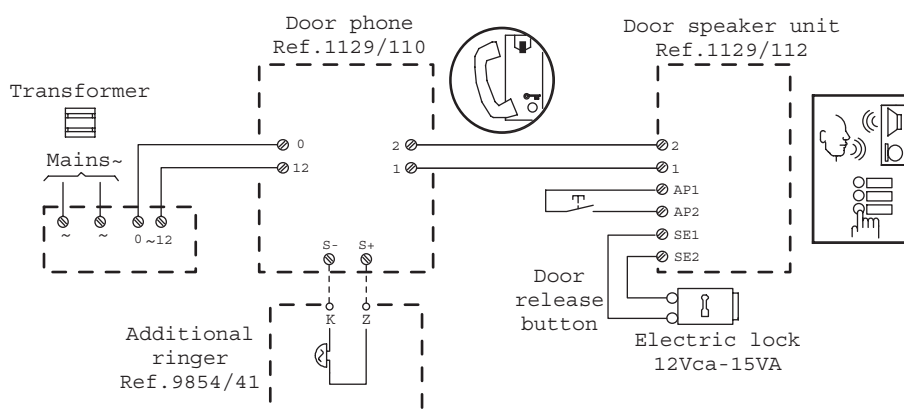

### CONNECTION OF A SUPPLEMENTARY DOOR PHONE IN PARALLEL TO A MAIN DOOR PHONE IN A ONE-FAMILY 2-WIRE AUDIO KIT

SC101-1308A

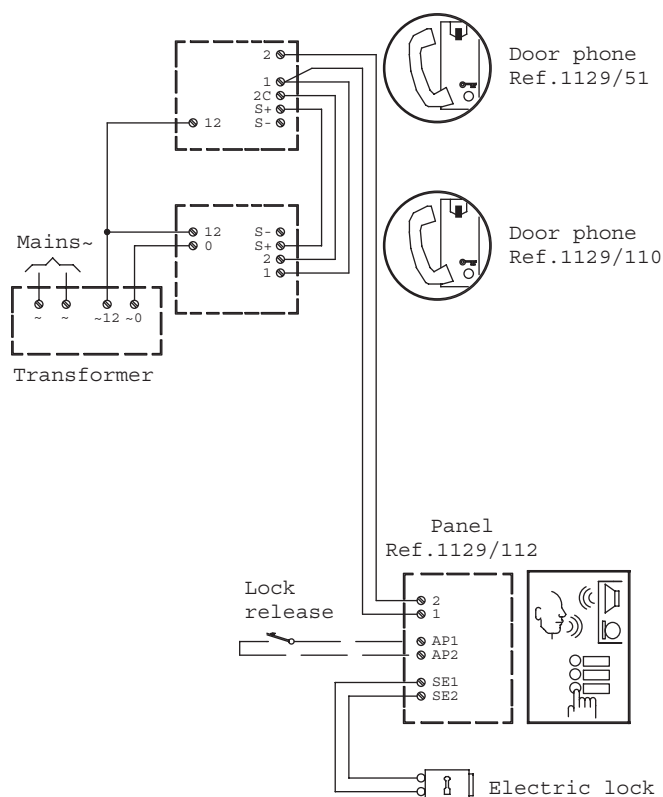

### CONNECTION OF 4 SUPPLEMENTARY DOOR PHONES IN PARALLEL TO A MAIN DOOR PHONE IN A ONE-FAMILY 2-WIRE AUDIO KIT

SC101-1309A

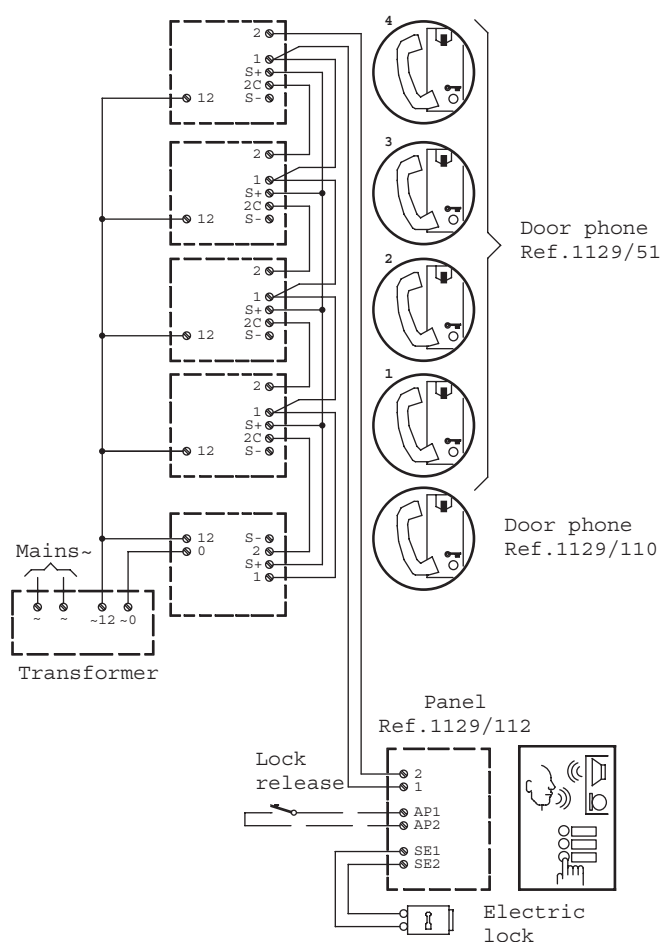



### 2-WIRE ONE FAMILY VIDEO KIT

The Urmet Domus Video Kits can be used to make one-family video door phone systems without coax wire using only two wires to connect the video door phone to the video door unit.

The following versions of the Video Two one-family kits are available:

- Black/white with plastic panel **Ref. 952/11**
- Colour with plastic panel **Ref. 952/41**
- Black/white with zama vandal-proof panel **Ref. 952/21**
- Colour with zama vandal-proof panel **Ref. 952/51**

**NOTA:** the panels with plastic casing are provided with 35 x 56mm name tags; those with zama casing are provided with 15 x 56mm name tags.

Conversation between door unit and apartment unit can only be established after the apartment unit has been called. Call is two-tone electronic. The camera fits a high-sensitivity semi-pinhole camera. The subject is illuminated by LEDs. The video door phone has a door opener button and two special function buttons (auto-on, staircase lights, etc.).

#### System block chart

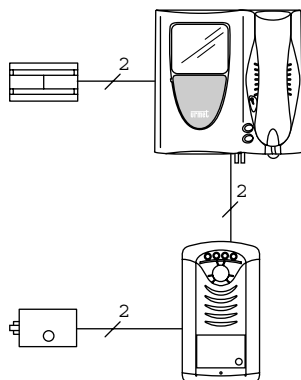

Press the button on the panel: the call is sent to the monitor and the picture will appear after approximately 4 seconds. The call tone will last for approximately five seconds. Lift the handset to stop the call tone and speak with the video door phone. The monitor switch-on is timed (approximately 90 seconds). Any subsequent call or automatic switch-on will reset the timer.

### DEVICES

The basic product configuration is as follows:

- One button camera unit.
- Video door phone with bracket Atlantico style.
- Power supply.

### ACCESSORIES

The following accessories can be purchased separately:

- Max 1 supplementary ringer **Ref. 9854/41**
- or
- Max 1 supplementary door phone **Ref. 1133**
- or
- Max 1 Atlantico supplementary Videodoorphone black and white **Ref. 1702/1**
- colour **Ref. 1702/40**
- Table mounting kit **Ref. 1702/92**
- Coloured mask kit **Ref. 1702/50**
- Wall bracket for supplementary video door phone **Ref. 1202/90**

### SPARE PARTS

The following spare parts are provided for repairs:

- Power supply **Ref. 952/100**
- Camera unit
  - black and white **Ref. 952/112**
  - colour **Ref. 952/113**
- Atlantico video door phone
  - black and white **Ref. 1702/1**
  - colour **Ref. 1702/40**
- Bracket for Atlantico videodoor phone **Ref. 952/111**
- Spare handset **Ref. 1702/101**

### TECHNICAL FEATURES

#### VIDEO DOOR PHONE B/W (black and white) version

Power supply: 26Vdc  
Kinescope: 4" Flat  
Resolution: 450 TV lines  
Ringer: electronic two-tone  
Dimensions: 218 x 220 x 80mm

#### VIDEO DOOR PHONE (Colour version)

Power supply: 26Vdc  
Kinescope: 4" colour LCD  
Resolution: 234 TV lines  
Ringer: electronic two-tone  
Dimensions: 218 x 220 x 80mm

#### CAMERA UNIT B/W (black and white) version

Camera: CCD 1/3"  
Lighting: infrared LED  
Power supply: 18Vdc  
Timer: approximately 90"  
Dimensions: 185 x 99 x 35mm

#### CAMERA UNIT (Colour version)

Camera: CCD 1/4"  
Lighting: White LEDs  
Power supply: 18Vdc  
Timer: approximately 90"  
Dimensions: 185 x 99 x 35mm

#### POWER SUPPLY

Power supply: 110/230Vac  $\pm$  10% 50/60Hz  
Power: 38VA  
Secondary unit: 26Vdc 0.9 A (timed 20%)  
Protections: with PTC thermal switch (\*)  
Dimensions: 96 x 126 x 75mm  
Weight: 1.1kg

(\*) To restore the power supply if the PTC thermal switch trips following overload or short-circuit, power the unit down for 60 seconds or longer.

### WIRE CROSS-SECTION AREA

Distance	50m	100m
Power supply/Videodoor phone mm <sup>2</sup>	0,50	--
Videodoor phone/Camera mm <sup>2</sup>	0,50	0,75

**NOTE:** the basic kit connections are not polarised.



## 2-WIRE ONE FAMILY VIDEO KIT

## PANEL

**urmet**  
DOMUS

## PANEL

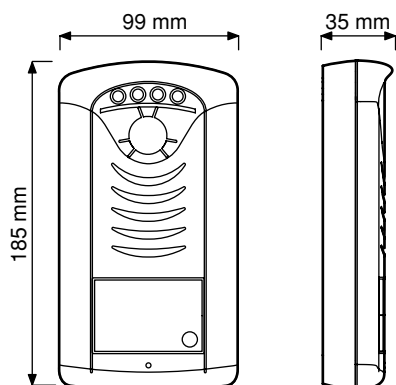

The camera unit is supplied complete with:

- Semi pin-hole camera.
- Led for lighting.
- Front plate with 1 button.
- Electronic circuit.
- Lamp for lighting the name tags.

Adjust volume (to be adjusted only when needed) and camera position.

## INSTALLATION

- Remove the name tag light circuit.

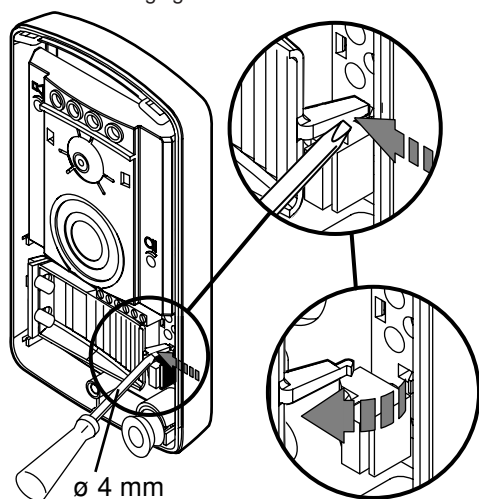

- Extract the door unit from the base.

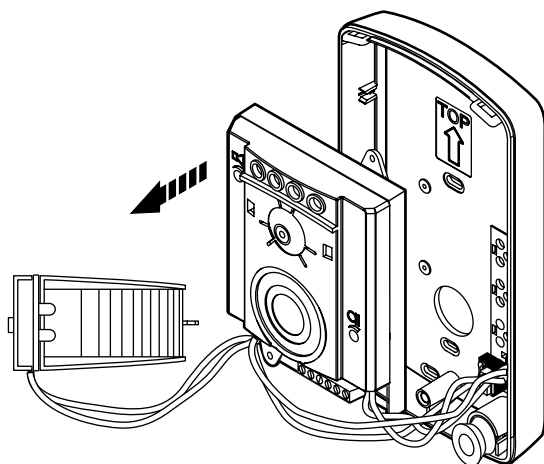

- Fasten the base onto a flat wall at the height shown in the figure using the bolts provided.

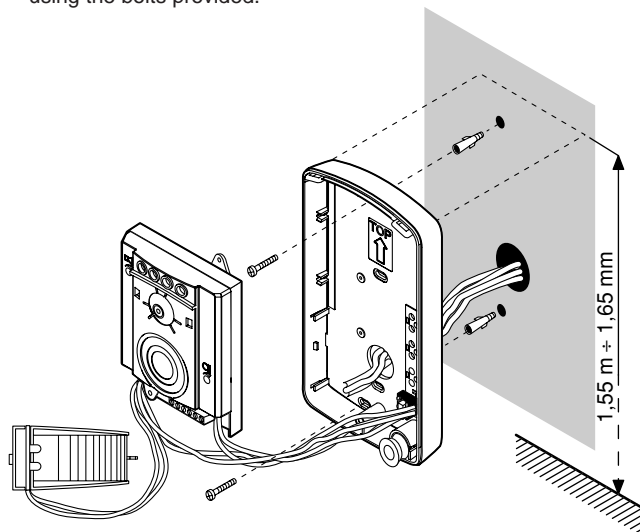

**NOTE:** the panels with plastic casing may also be fixed in a flush-mounting box Mod. 503 as shown below.

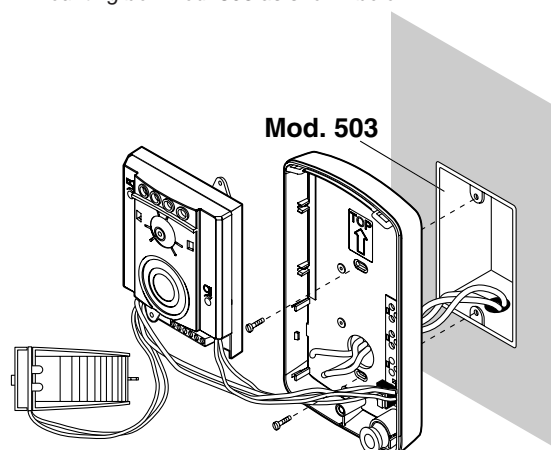

- Insert the door unit into the compartment in the based and connect the wires (it is advisable to have approximately 40-45 mm of wire protruding from the wall).

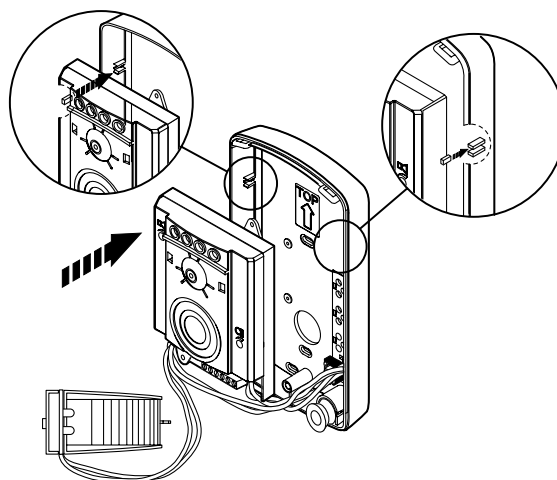

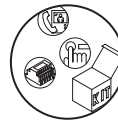

- Fasten the name tag light circuit making the wires pass underneath the support.

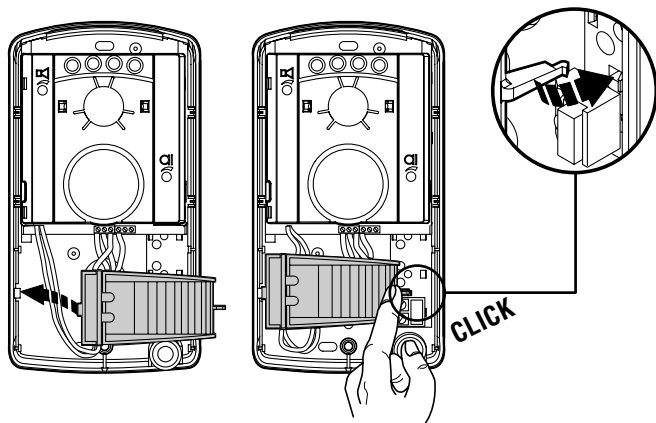

- Adjust volume and camera position. Volume is calibrated to optimal values during production. Change the settings when needed only.
- Set the electrical lock operating time by shifting the jumper to the required position.

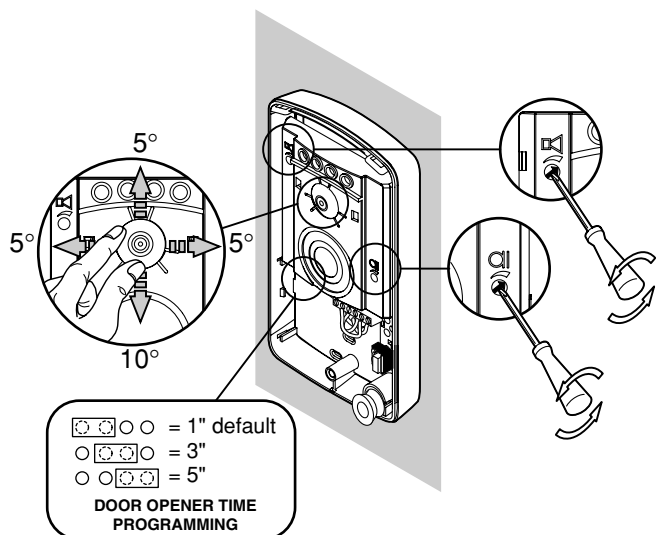

- Write the name on the name tag and insert in the housing.

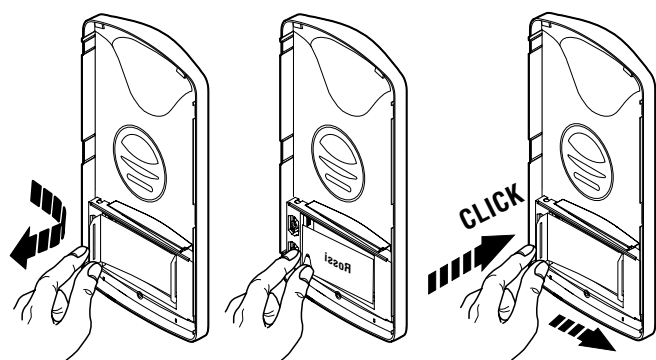
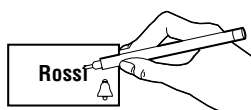

- Insert the front part of the panel on the base and fasten it with the socket head screw using the wrench (2mm) provided.

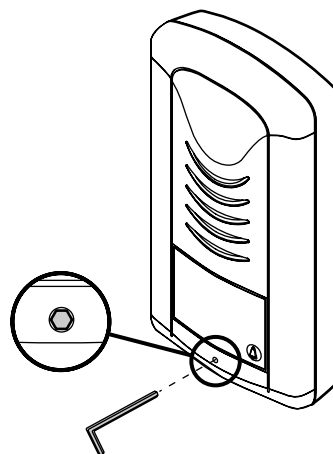
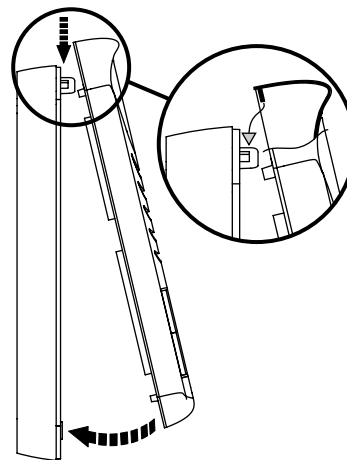



## 2-WIRE ONE FAMILY VIDEO KIT

### VIDEO DOOR PHONE - POWER SUPPLY

**urmet**  
DOMUS

### VIDEO DOOR PHONE

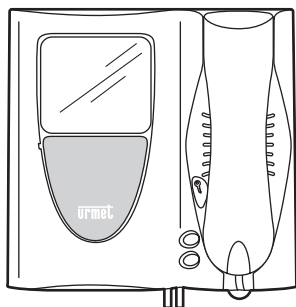

This wall-mounted video door phone apartment station with next generation flat 4" kinescope screen does not need to be flush-mounted given the minimum protrusion from the wall. Installation is extreme simple and fast because the connections are shown on the terminal boards arranged on the bracket.

The main characteristics of the video door phone are:

- Adjustable and mutable call volume. The adjustment wheel appears red when the volume is muted.

**NOTE:** when volume is set to "MUTE" the video door phone will not ring but the video module will light up.

- Door opener button is lit up and green when video module is on.
- Service buttons (◊ and ○) for activating, for example, supplementary electrical locks, staircase lights, video door phone auto-on function, etc.
- Adjustable brightness and contrast.

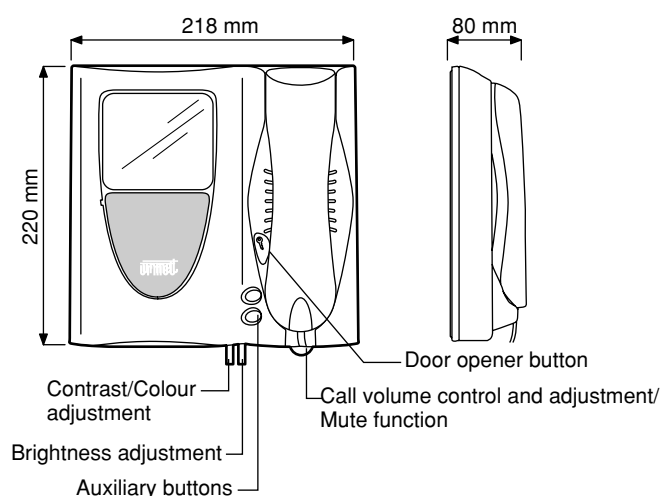

### INSTALLATION

- 1) Arrange the duct so that it ends in correspondence with one of the input holes.
- 2) Fasten the bracket to the wall at the height from the floor shown by means of the four screws.
- 3) Connect the wires to the specific terminals.
- 4) Check that switch on back of video door phone is in the **A** position.



- 5) Extract the retainer hook **A** by inserting the tip of a screwdriver and pulling the hook downwards.
- 6) Fasten the monitor to the bracket as shown in the figure.
- 7) Fasten the monitor by pushing the retainer hook **A** upwards.

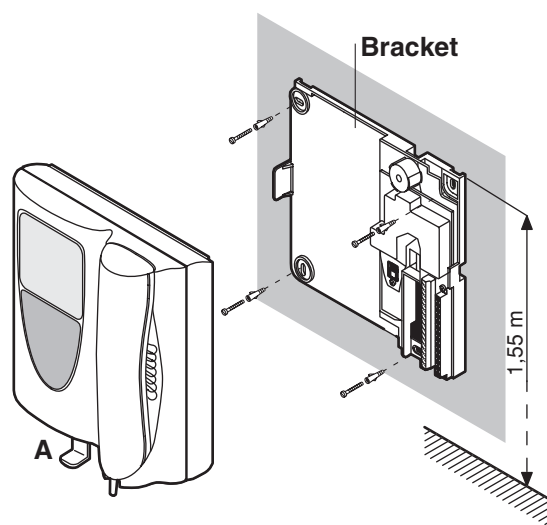

### POWER SUPPLY

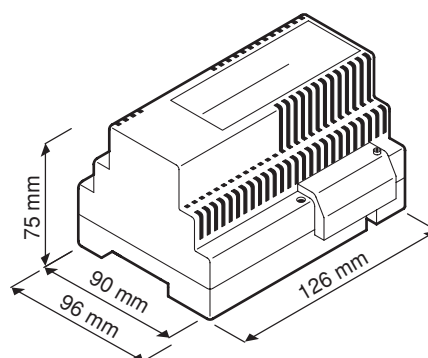

The power supply unit provides power to the entire system. It is connected to the monitor by means of two wires. It can be wall-fitted or fitted on DIN bar.

The power supply unit must be installed in dry places protected from weather conditions.

126mm in length correspond to seven 18mm modules, as per DIN 43880 standard.



**SV102-3216**

**BASIC  
VIDEO DOOR PHONE**

**+  
BRACKET**

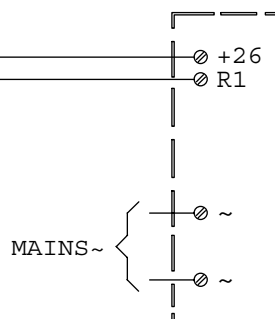
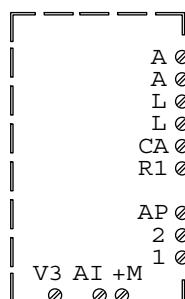
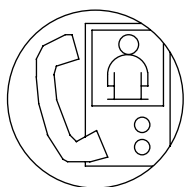

**VIDEO  
POWER SUPPLY**

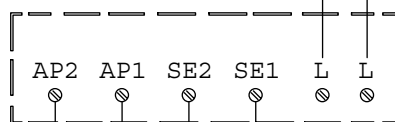

**Lock  
opening**



**Electrical  
Lock  
12Vca 15VA**

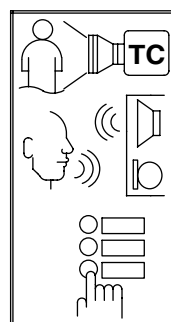

**VIDEO  
OUTDOOR STATION**



- A) Supplementary ringer Ref. 9854/41 Connection in parallel to 1 video door phone call  
B) Call repeater relay connection for controlling a supplementary ringer  
C) Connection of a secondary electrical lock

**urmet**  
DOMUS

## SV102-3217B

2-WIRE ONE FAMILY VIDEO KIT

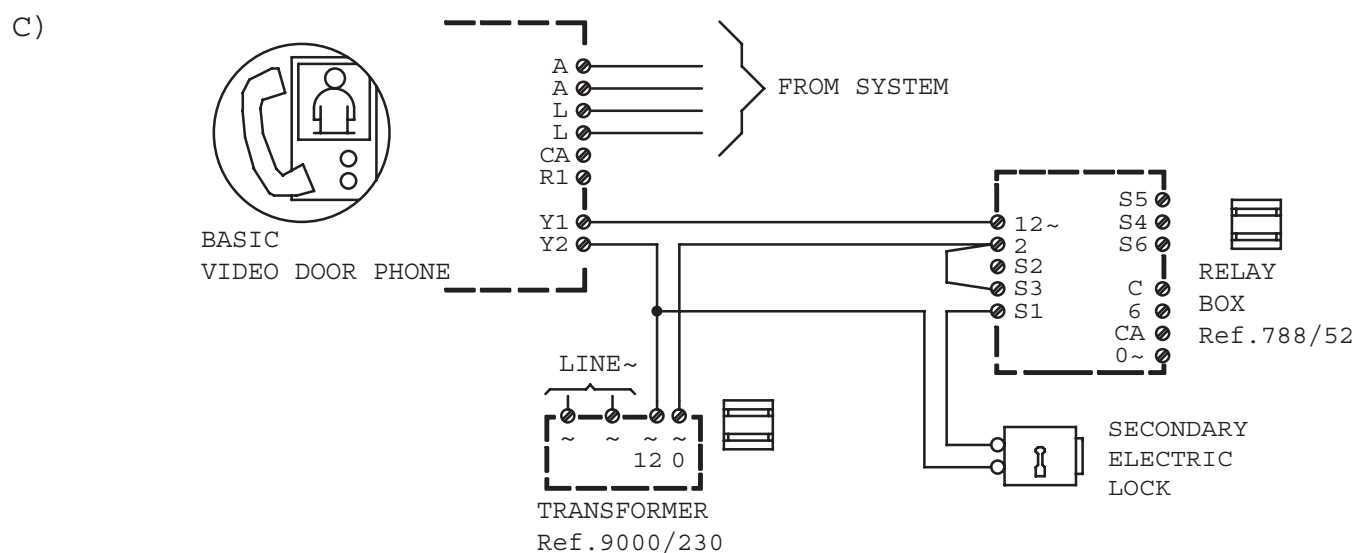
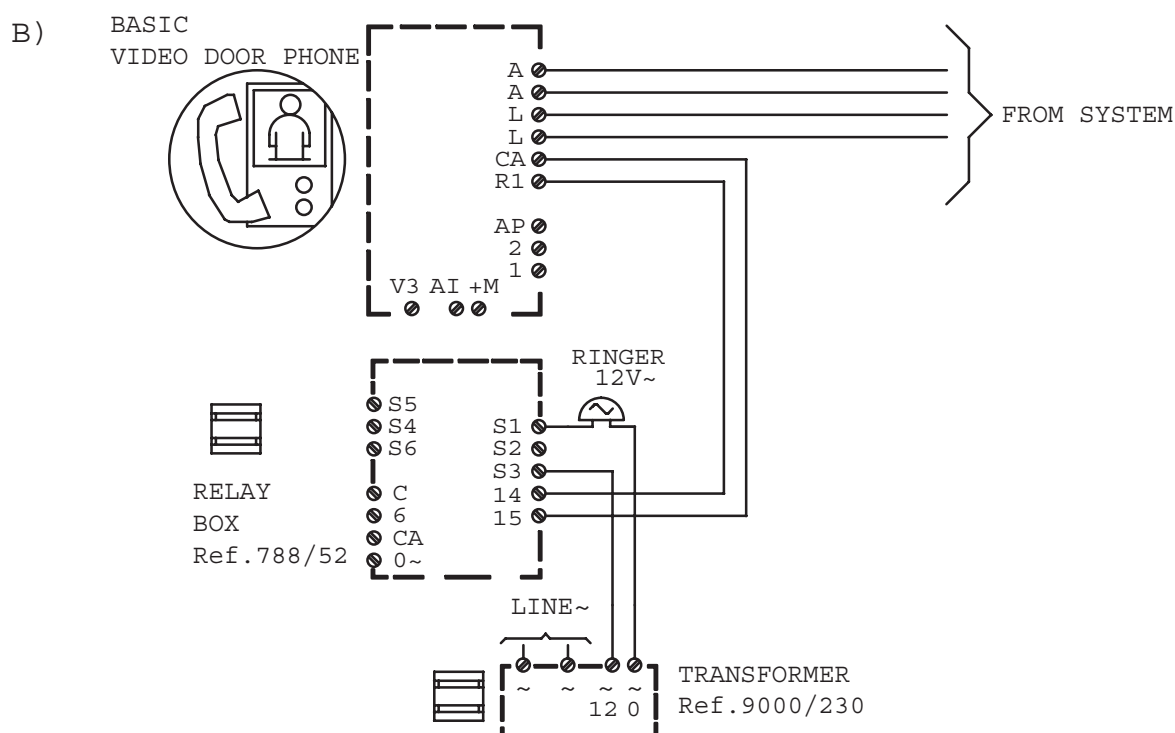
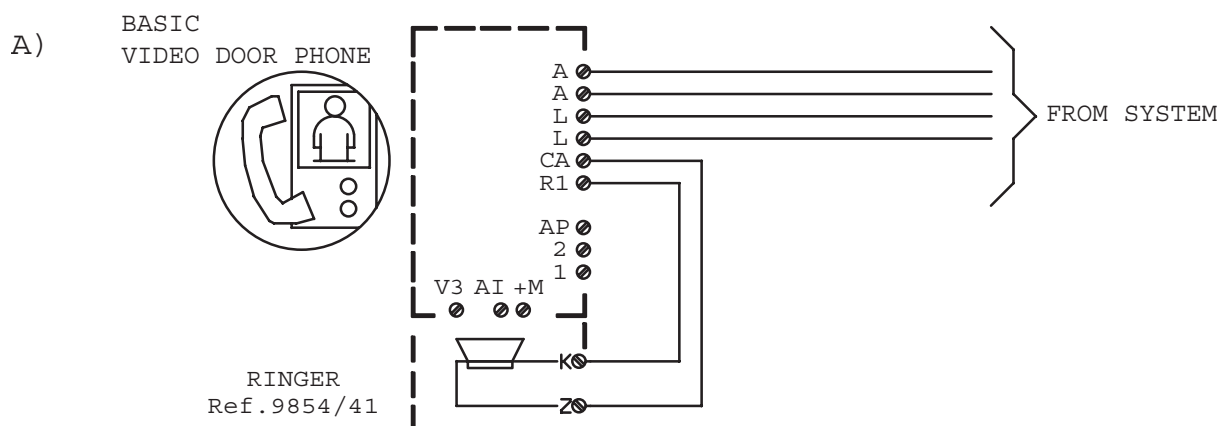

ONE-FAMILY AND TWO-FAMILY KITS



SV102-3218

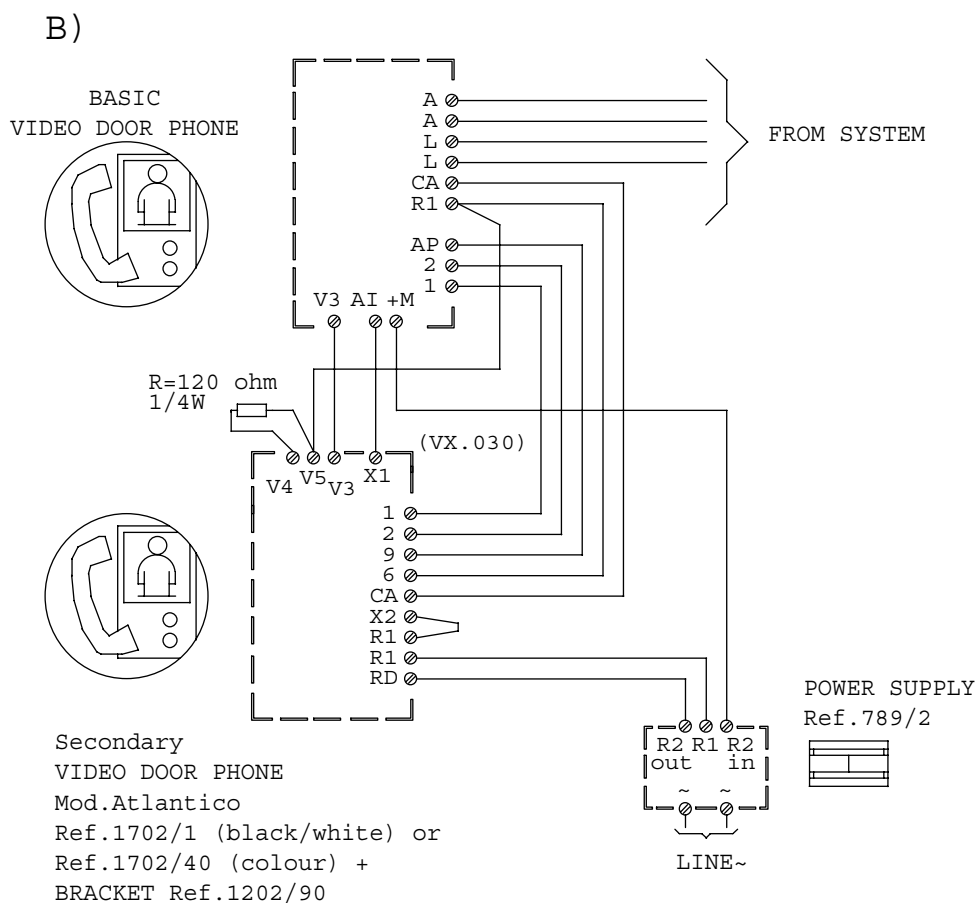
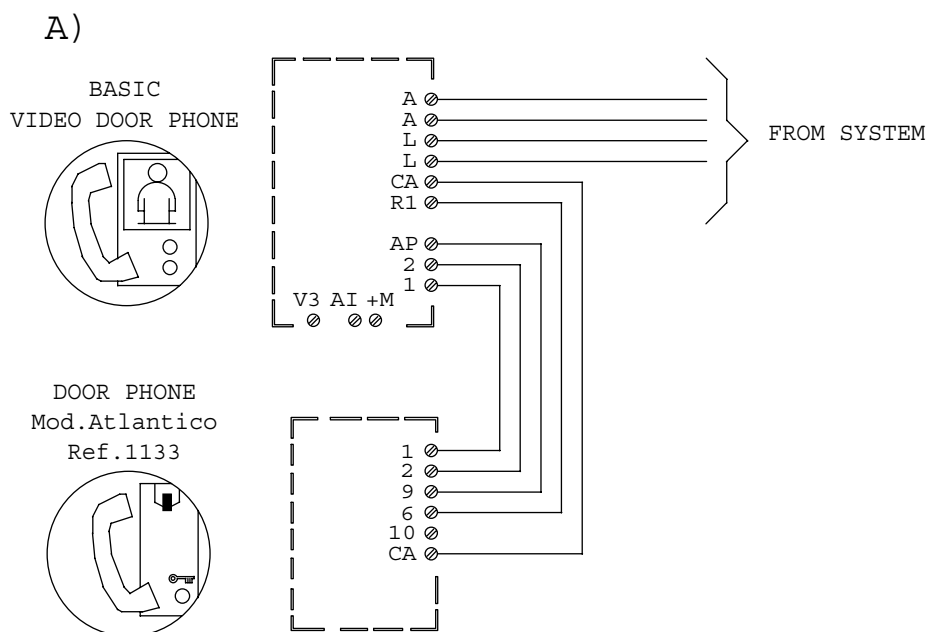

**VX.030** max. distance between basic and secondary video door phone  
(terminals V3-V5):

- normal wires 20m
- coax cable 50m



# ONE AND TWO-FAMILY VIDEO KIT Mod. 956 WITH ARTICO VIDEO DOOR PHONE

EQUIPMENT - ACCESSORIES - SPARE PARTS - TECHNICAL FEATURES - WIRE SECTIONS

**urmet**  
DOMUS

## ONE AND TWO-FAMILY VIDEO KIT Mod. 956 WITH ARTICO VIDEO DOOR PHONE

Urmet Domus video door phone system Mod. 956 allows single and two-user video systems without coax cable and with a reduced number of wires: 4 common wires + 1 calling wire for each monitor.

The 4" monitor with flat screen does not need any embedding and, as for Urmet Domus traditional video door phone system, the image appears only on the called monitor.

The conversation between the outdoor station and the monitor can take place even if the indoor set has not been called.

The call is electronic bitonal type; the TV camera unit uses a CCD TV camera; the subject is lighted by means of infrared Leds.

The monitor is equipped with a door-release key and 2 additional keys that can be used for any service or as self-insertion key: in this case the system needs an additional wire in conduit.

### Block diagram for two family system

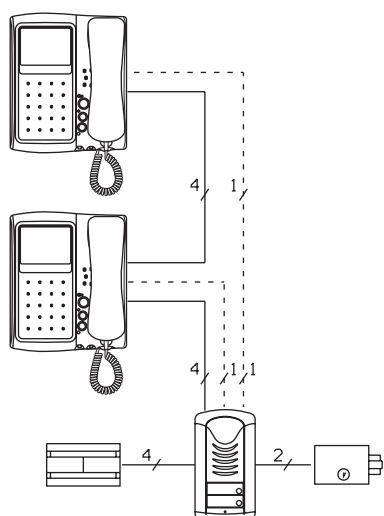

By pressing a button of the push button panel the call is sent to the monitor on which the image appears after 4" about.

By unhooking the handset, the conversation with the video outdoor station can take place.

Monitor lighting is timed (one minute about). Every new call cancels the previous one with timer reset.

## EQUIPMENT

The products are the following:

- One-family video door phone kit (230Vac 50Hz) **Ref. 956/31**  
Composed by:
  - Smyle Camera with 1 button
  - Artico video door phone with bracket
  - Power supply
- Two-family video door phone kit (230Vac 50Hz) **Ref. 956/32**  
Composed by:
  - Smyle Camera with 2 buttons
  - 2 Artico video door phones with bracket
  - Power supply
- One-family video door phone kit (110Vac 60Hz) **Ref. 956/19**  
Composed by:
  - Smyle Camera with 1 button
  - Artico video door phone with bracket
  - Power supply
- Two-family video door phone kit (110Vac 60Hz) **Ref. 956/29**  
Composed by:
  - Smyle Camera with 2 buttons
  - 2 Artico video door phones with bracket
  - Power supply

## ACCESSORIES

- Max 1 Atlantico door phone **Ref. 1133/35A**  
or
- Max 1 supplementary ringer **Ref. 9854/41**
- Call repeater relay **Ref. 788/52**
- Blue screen **Ref. 1705/102**
- Transformer (230Vac 50Hz) **Ref. 9000/230**
- Transformer (110Vac 60Hz) **Ref. 9000/110**

## SPARE PARTS

The possible spare parts for repair are the following:

- Camera **Ref. 956/123**
- Panel with 1 button **Ref. 1729/1**
- Panel with 2 buttons **Ref. 1729/2**
- Power supply **Ref. 956/110**
- Bracket for video door phone **Ref. 1705/955**
- Video door phone (CCIR Version 50Hz) **Ref. 1705/1**
- Video door phone (EIA Version 60Hz) **Ref. 1705/18**
- Grey screen **Ref. 1705/101**

## TECHNICAL FEATURES

### VIDEO DOOR PHONE

Power supply:	18Vdc max
Consumption:	600 mA max
Kinescope:	4" Flat
Resolution:	450 TV lines
Video input:	1Vpp differential
Ringer:	electronic two-tone
Dimensions:	200 x 241 x 83mm

### CAMERA UNIT

Camera:	CCD
Lighting:	infrared LED
Power supply:	18Vdc max
Timer:	approximately 45"
Video output:	1Vpp differential
Dimensions:	185 x 99 x 35mm

### POWER SUPPLY

Power supply:	110/230Vac $\pm$ 10% 50/60Hz
Power:	38VA
Secondary unit:	12Vac 1A + 1A (timed 30%) 18Vdc 1A (timed 10%)
Protections:	with PTC thermal switch PTC (*)
Dimensions:	96 x 126 x 75mm
Dissipated power after 1 average working hour:	4,2W

Length of 126 mm corresponds to seven 18 mm modules in accordance with DIN 43880 standards.

Weight: **1,1Kg**

(\*) To restore the power supply if the PTC thermal switch trips following overload or short-circuit, power the unit down for 60 seconds or longer.

## WIRE SECTIONS

### FROM TV CAMERA UNIT TO MONITORS

Function	Wires	m	50m	100m	200m
Video power supply	R1	S/mm <sup>2</sup>	0,5	0,75	1,5
Video power supply	R2	S/mm <sup>2</sup>	0,5	0,75	1,5
Video signal	A	S/mm <sup>2</sup>	0,35	0,35	0,35 twisted
Video signal	B	S/mm <sup>2</sup>	0,35	0,35	0,35
Call	C1 - C2	S/mm <sup>2</sup>	0,35	0,5	0,75
Self-insertion call	AI	S/mm <sup>2</sup>	0,35	0,35	0,35



Distances are between the TV camera unit and the last monitor. Up to 100m it is possible to use normal wires; for longer distances, up to 200m, twist the wires A and B.

#### FROM POWER SUPPLY TO TV CAMERA UNIT

Function	Wires	m	50m	100m
Power supply 12V~	~12	S/mm <sup>2</sup>	0,5	0,75
Power supply 12V~	~0	S/mm <sup>2</sup>	0,5	0,75
Power supply 18V ==	+18	S/mm <sup>2</sup>	0,35	0,35
Power supply 18V ==	R1	S/mm <sup>2</sup>	0,35	0,35

#### CAMERA UNIT

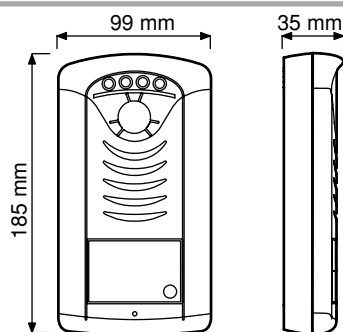

The camera unit is fitted in a Smyle panel. The unit includes:

- Camera with solid state CCD sensor.
- Infrared LED lights.
- Front panel with 1 or 2 buttons.
- Electronic circuits.
- Name tag light LED.

The internal and external sound volumes can be adjusted by operating on the proper controls.

#### INSTALLATION

- Remove the name tag light circuit.

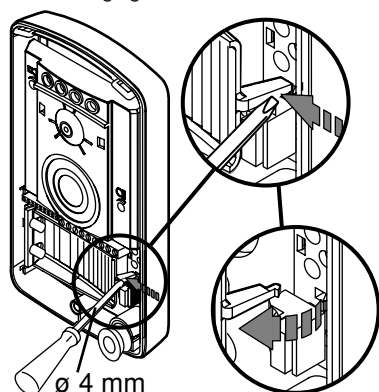

- Extract the door unit from the base.

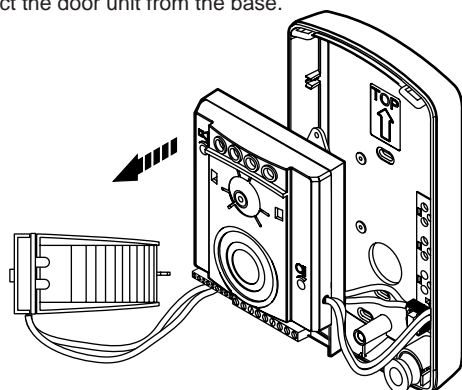

- Fasten the base onto a flat wall at the height shown in the figure using either the bolts provided or a 503 box.

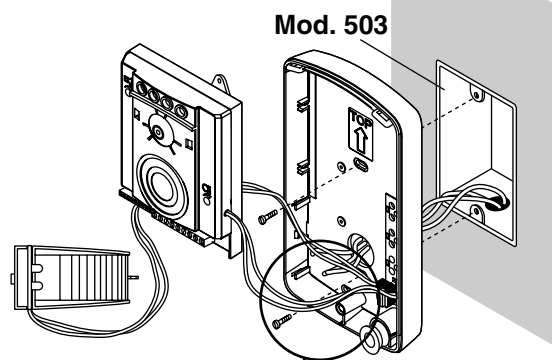
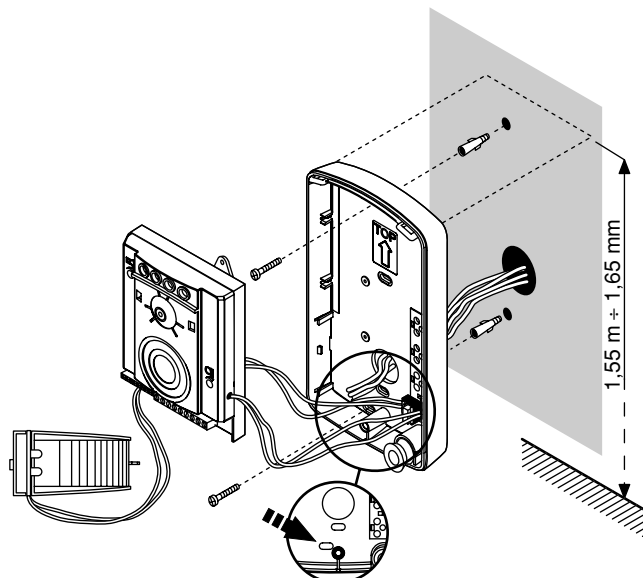

- Insert the door unit into the compartment in the based and connect the wires (it is advisable to have approximately 40-45mm of wire protruding from the wall).

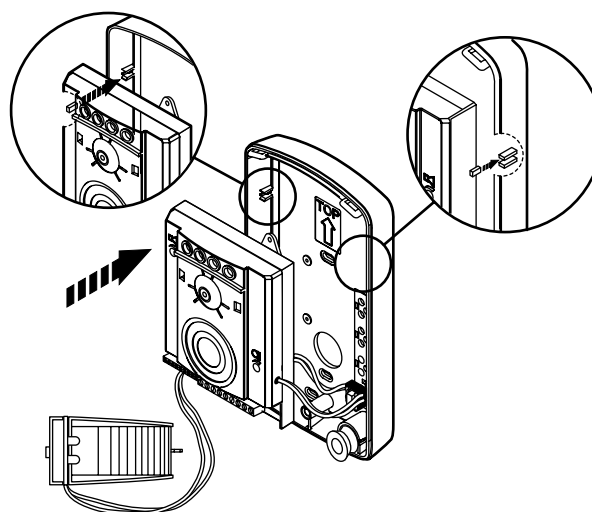



# ONE AND TWO-FAMILY VIDEO KIT Mod. 956 WITH ARTICO VIDEO DOOR PHONE

**urmet**  
DOMUS

## CAMERA UNIT

- Fasten the name tag light circuit making the wires pass under neath the support; then adjust volume and camera position.

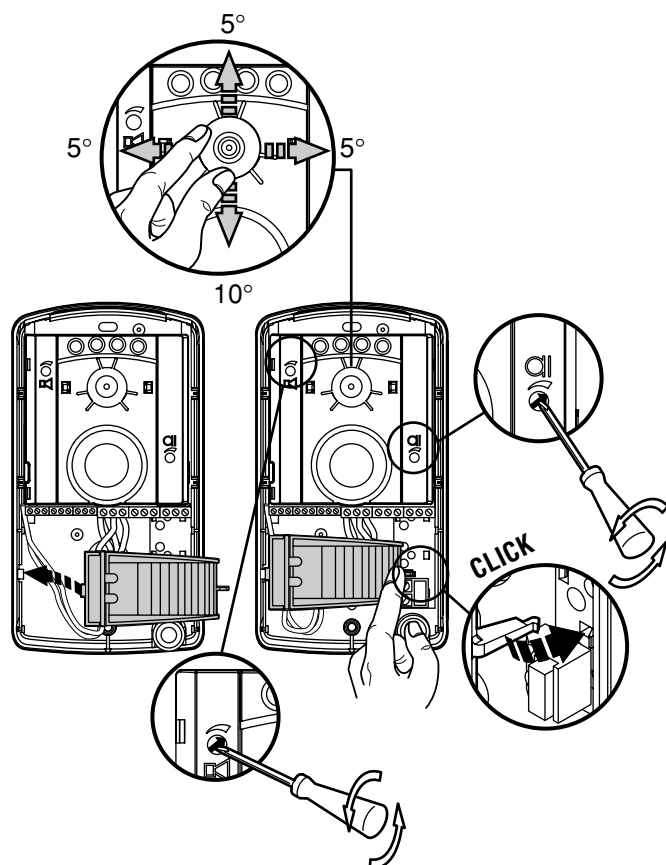

**NOTE:** volume is calibrated to optimal values during production. Change the settings when needed only.

- Write the name on the name tag and insert in the housing.

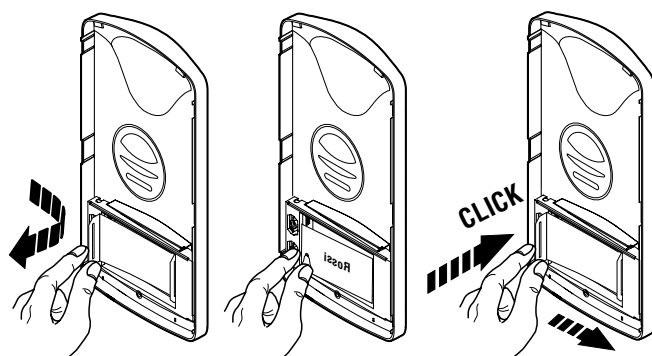
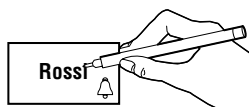

- Insert the front part of the panel on the base and fasten it with the socket head screw using the wrench (2mm) provided.

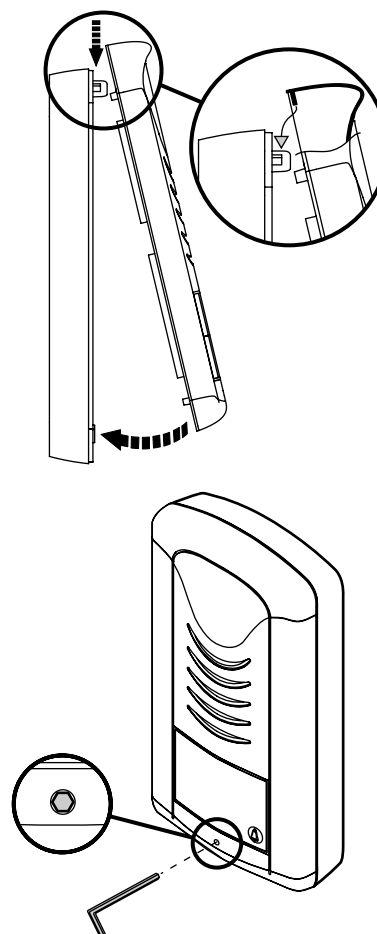

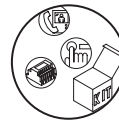

## VIDEO DOOR PHONE

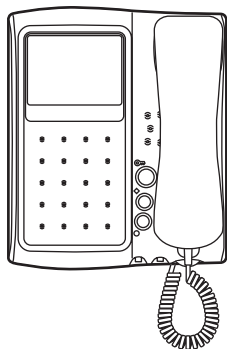

The main characteristics of the video door phone are:

- Flat 4" video module
- Adjustable and mutable call volume. The adjustment wheel appears red when the volume is muted.

**Note:** when volume is set to "MUTE" the video door phone will not ring but the video module will light up.

- Door opener button.
- Service buttons (◇ and ○).
- Adjustable brightness and contrast.

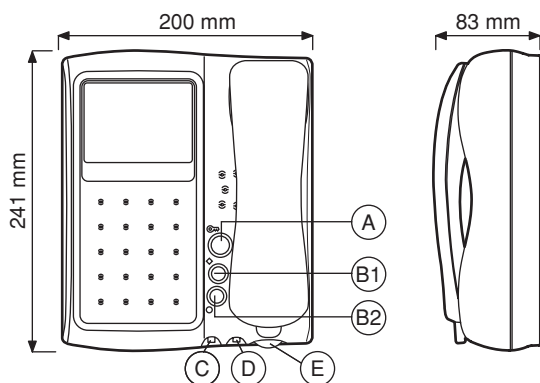

**A Door opener button.**

**B1 Auxiliary button:** used for special functions.

**B2 Auxiliary button:** used for special functions.

**C Contrast/colour adjustment control.**

**D Brightness adjustment control.**

**E Call volume control and adjustment:** turn the knob as far as it will go (red part visible) to mute the call tone ("MUTE" function).

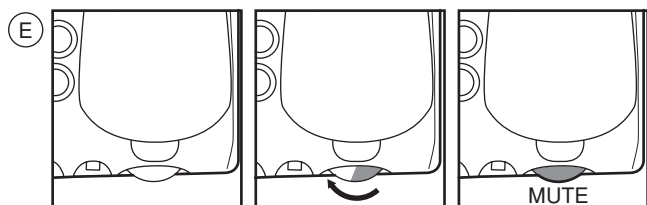

## INSTALLATION

- 1) Prepare the conduit so that it terminates at the infed hole provided.
- 2) Use 4 plugs to fasten the bracket to the wall at the height from the floor indicated.
- 3) Connect the wires to the specific terminals.
- 4) Extract the fastening hook **A**.
- 5) Insert the video door phone in the bracket.
- 6) Fasten the video door phone in place pushing hook **A** inwards.

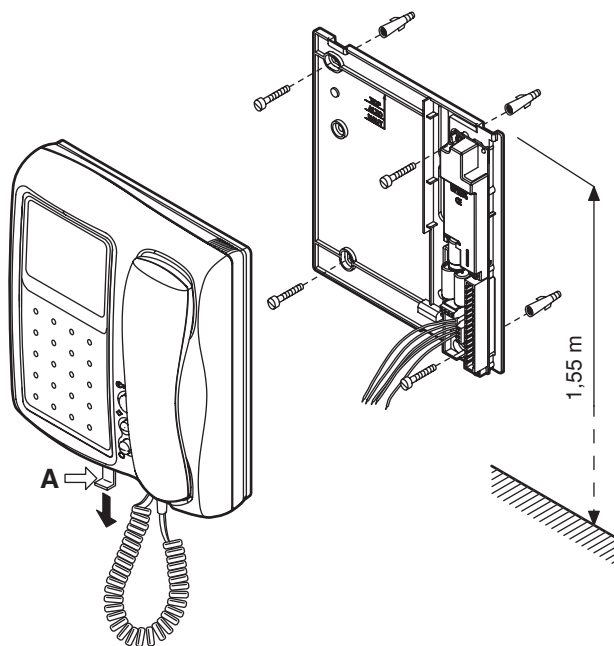

## POWER SUPPLY

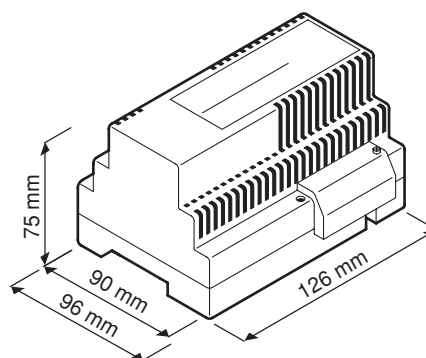

The power supply unit provides power to the entire system. It is connected to the monitor by means of two wires. It can be wall-fitted or fitted on DIN bar.

The power supply unit must be installed in dry places protected from weather conditions.

126mm in length correspond to seven 18mm modules, as per DIN 43880 standard.



**SV102-2082C**

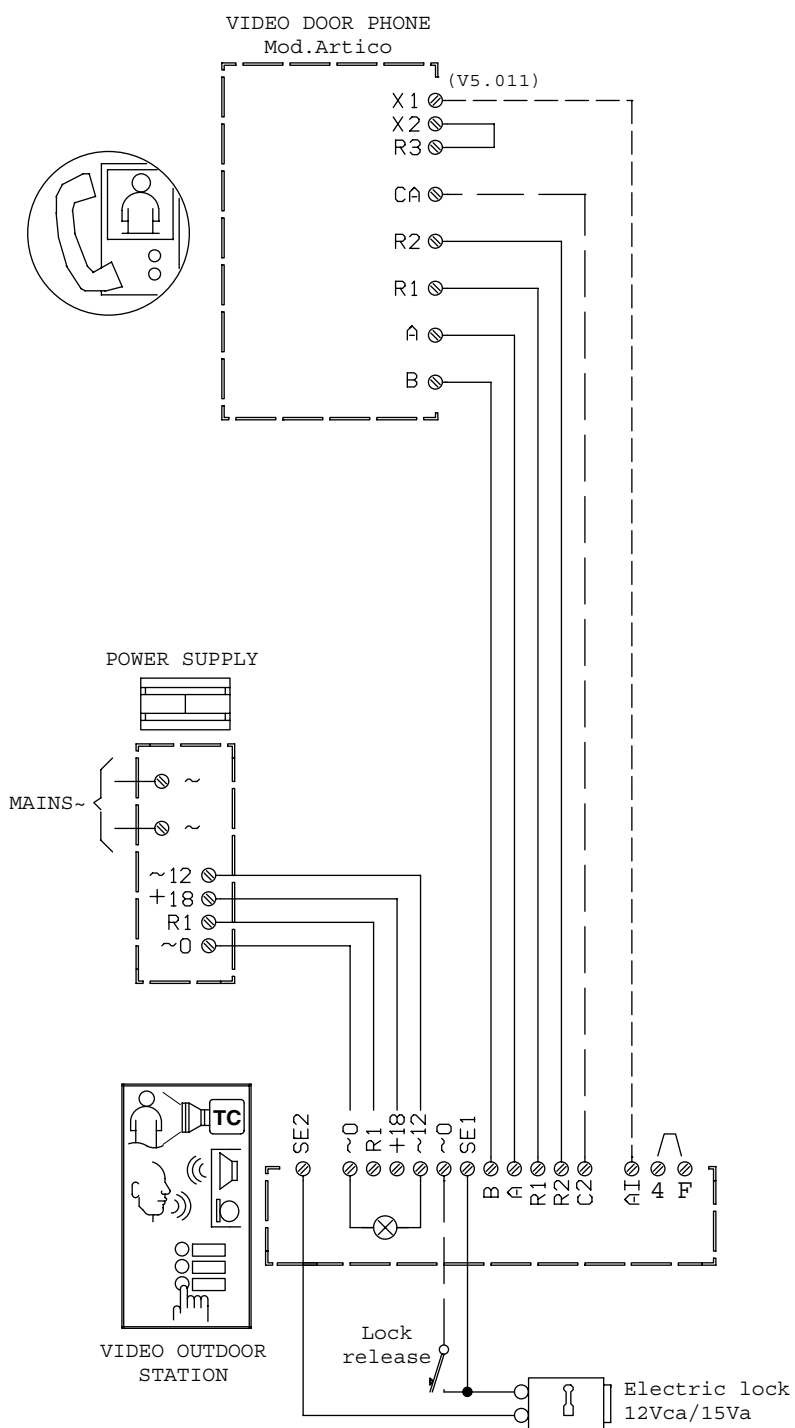

**V5.011** Connect the wire for Self-insert function. In this case make a jumper between terminals X2 and R3.



**SV102-2081B**

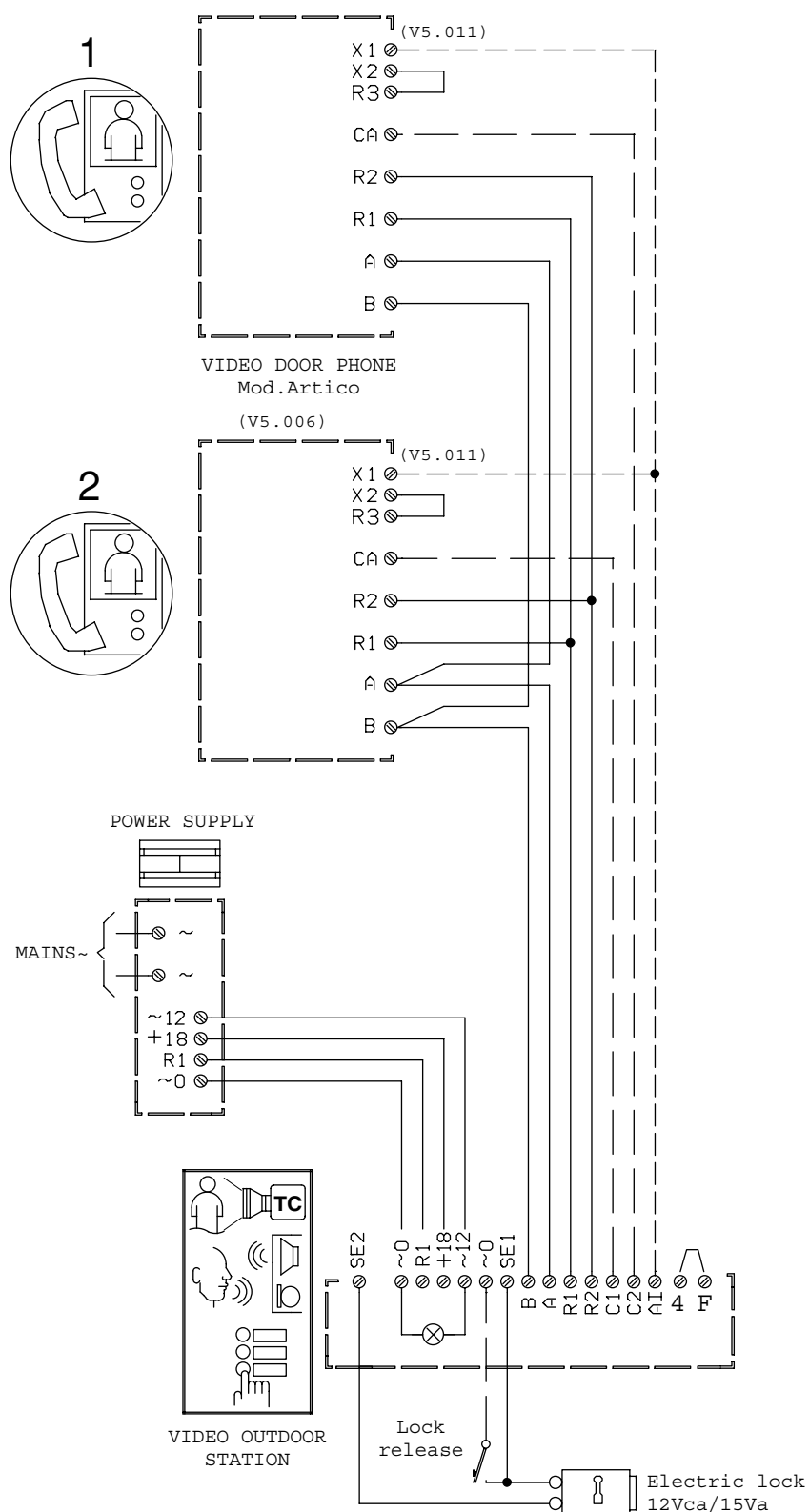

**V5.006** The maximum distance between devices is 50 metres.

**V5.011** Connect the wire for Self-insert function. In this case make a jumper between terminals X2 and R3.

SV102-2135C

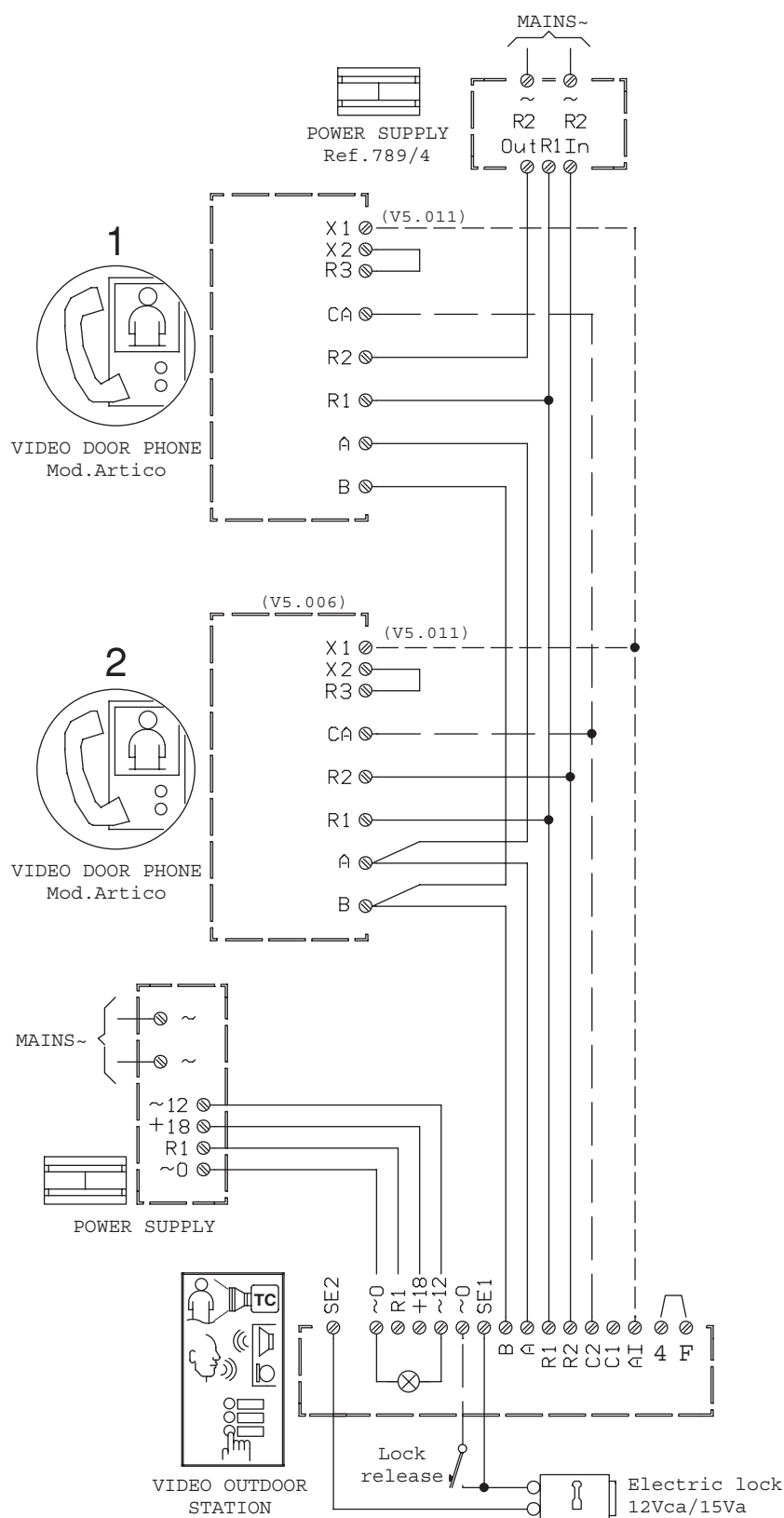

**V5.006** The maximum distance between devices is 50 metres.

**V5.011** Connect the wire for Self-insert function. In this case make a jumper between terminals X2 and R3.



**SV102-3225**

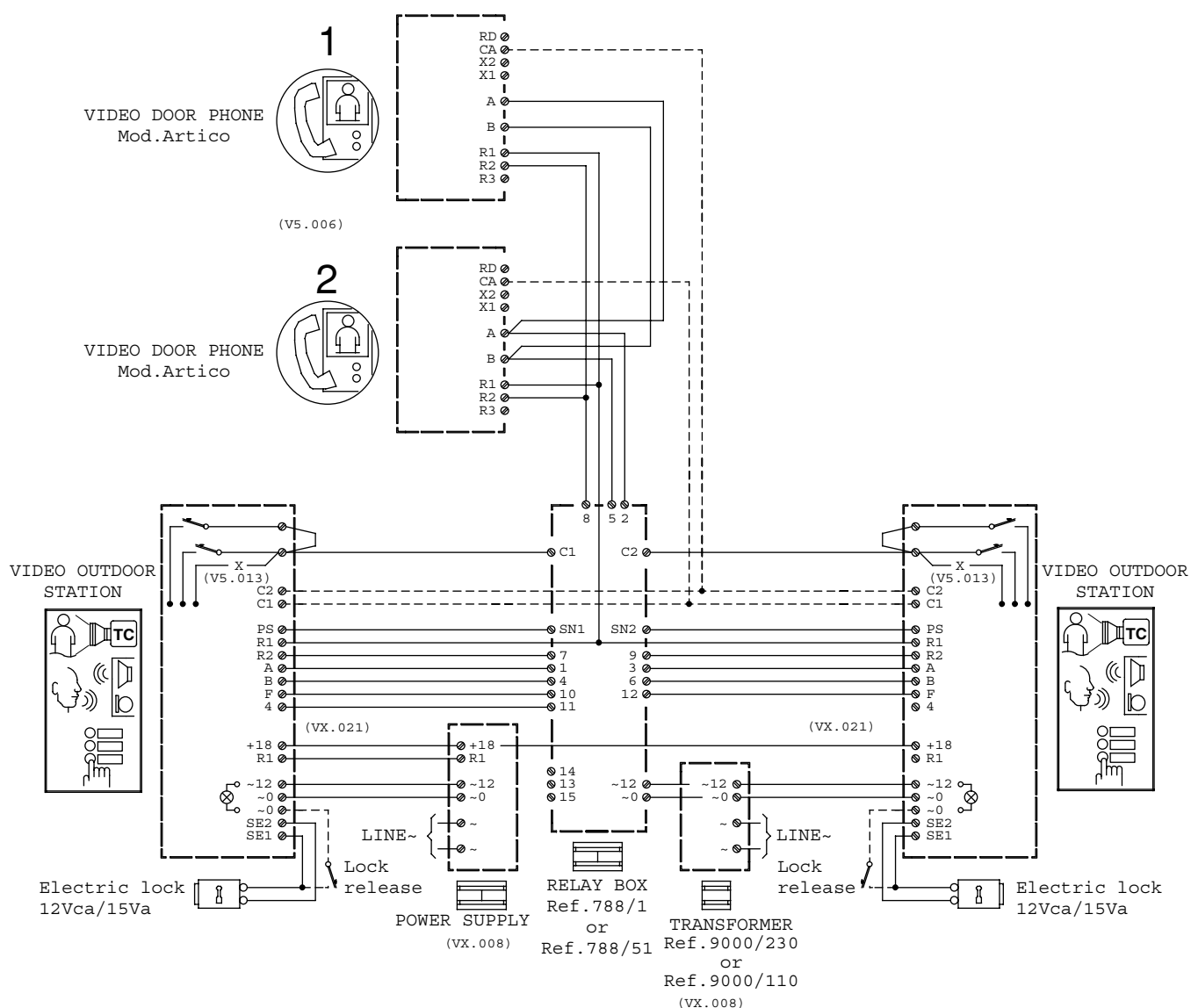

**V5.006** The maximum distance between devices is 50 metres.

**V5.011** Connect the wire for Self-insert function. In this case make a jumper between terminals X2 and R3.



# CONNECTION OF 1 DOOR PHONE IN PARALLEL TO 1 VIDEO DOOR PHONE SIMULTANEOUS OPENING OF 2 LOCKS

**urmet**  
DOMUS

SV102-2136E

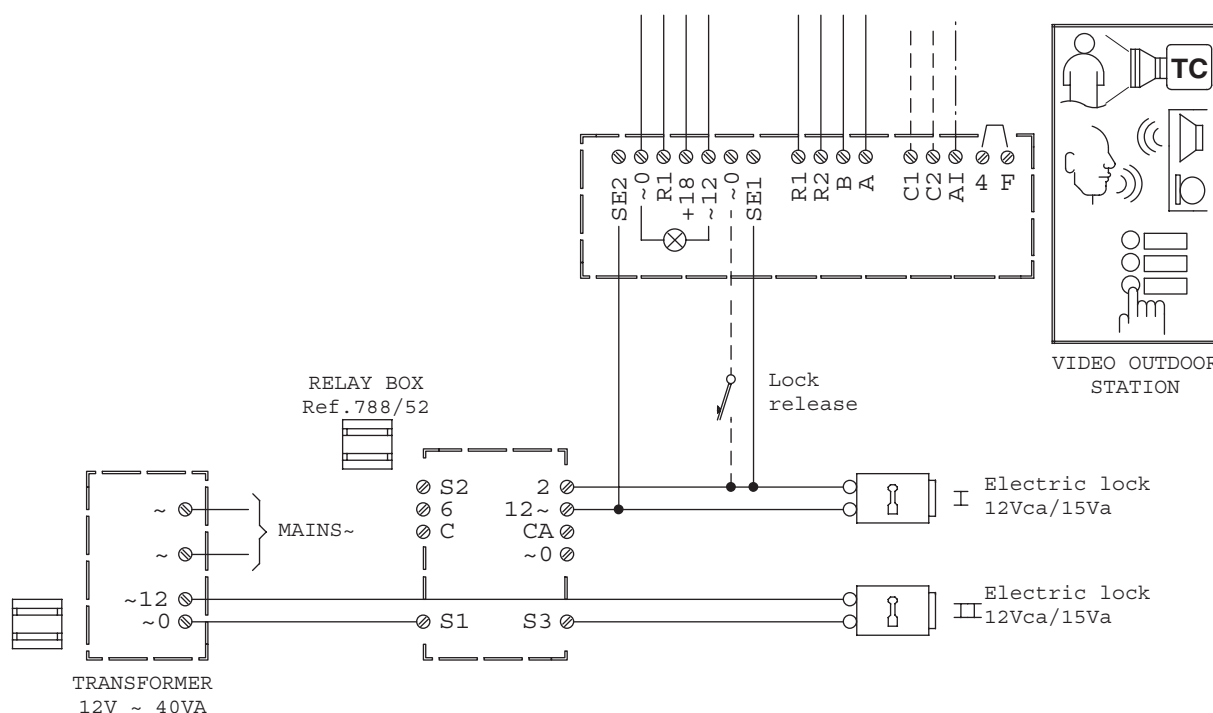
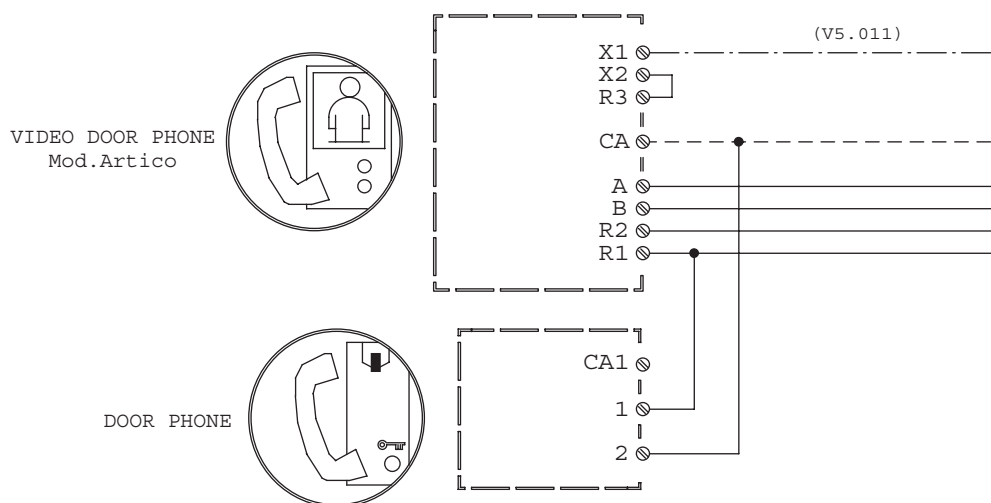

**V5.011** Connect the wire for Self-insert function. In this case make a jumper between terminals X2 and R3.

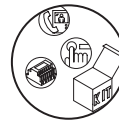

**SV102-2137D**

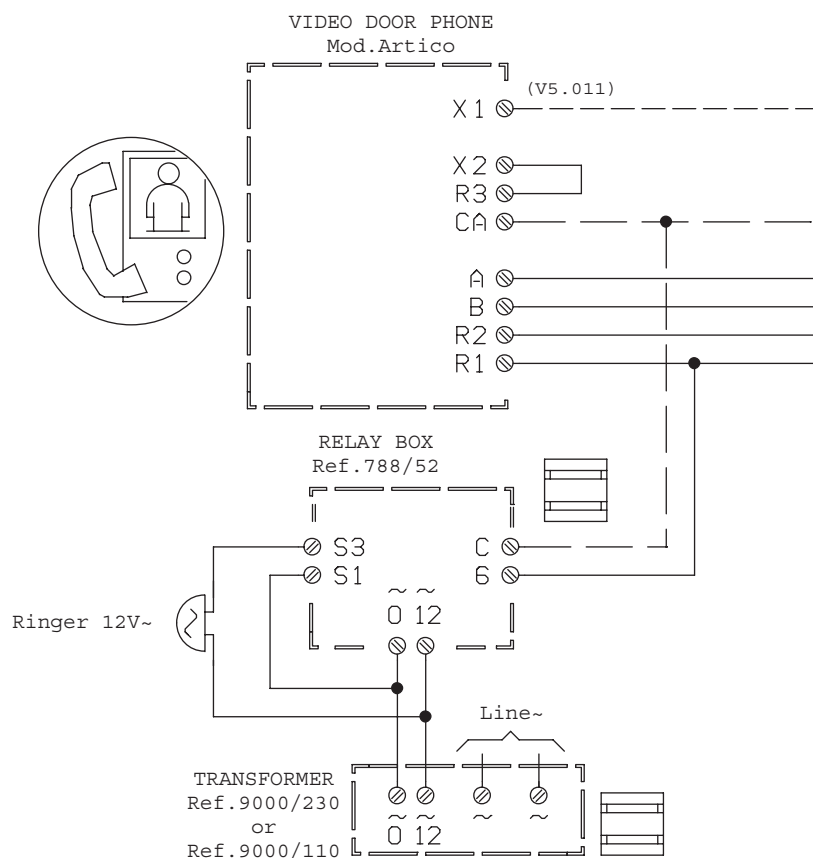
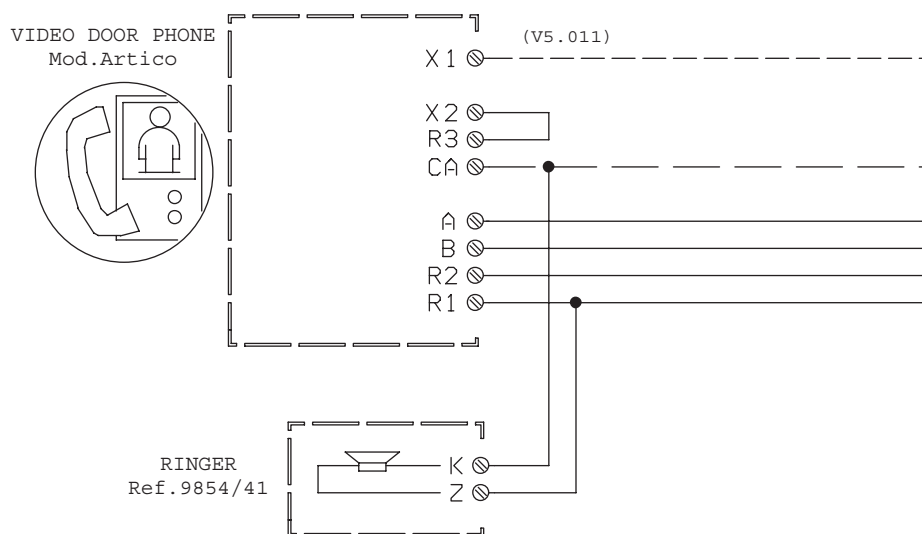

**V5.011** Connect the wire for Self-insert function. In this case make a jumper between terminals X2 and R3.

